

# Electrical Current Transmitter





## Benefits

- ✔ Easy installation
- ✔ Wide measuring range
- ✔ Accurate current sensing
- ✔ 4 ... 20 mA output signal
- ✔ IP67 casing provides robust protection in the industrial environment

### Accurate current measurement

SUTO current sensor is an AC RMS current sensor composed of a flexible active part (Rogowski coil model) connected to a compact digital converter, capable of measuring the current carried on a power conductor up to a value of 3000 A AC. The digital converter supplies an output of 4 ... 20 mA DC in linear proportion to the measured current.

### Current Transmitter Application

- Current sensing at compressors for load / unload analysis
- Current sensing for power / energy measurement
- Evaluation of machine operation hours

### Position Sensitivity

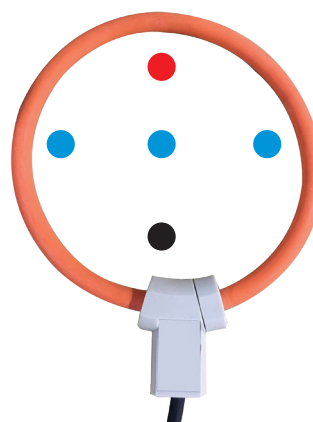

Conductor Position	Typical Error(%)
● (Red)	<0.5%
● (Blue)	<0.8%
● (Black)	<1%

### Single Phase Power Measurements

By measuring the current of a symmetric power consumer on one phase, compressed air experts are able to calculate the power consumption of the compressors without the need of measuring voltage additionally.

This offers an analysis of the compressor and allows to judge the efficiency of the system.

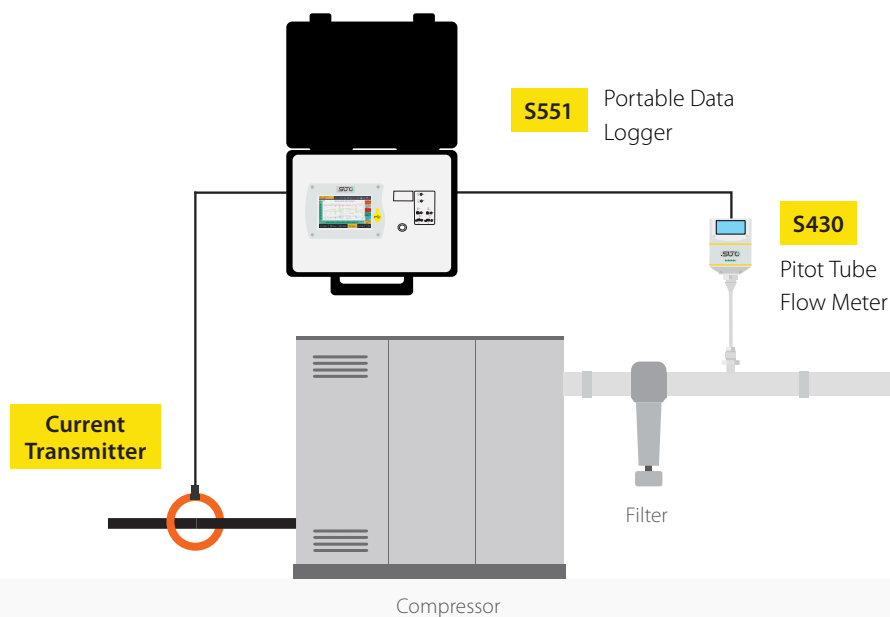

# Technical Data

## Measurement

### Current

Accuracy 0,5 % of reading + 0,2 % of range

## Signal / Interface & Supply

### Analog output

Signal 4 ... 20 mA 3-wire  
 Scaling 4 mA = 0A AC,  
 20 mA = 1000A / 3000 A AC  
 Load Max. 300 Ohm

### Supply

Voltage supply 10 – 32 VDC  
 Current consumption Max. 30 mA

### Data interface

Connection open wire ends / ODU connector

## General data

### Miscellaneous

Protection class IP67

Approvals CE

### Operating conditions

Ambient temperature 0 ... +80 °C

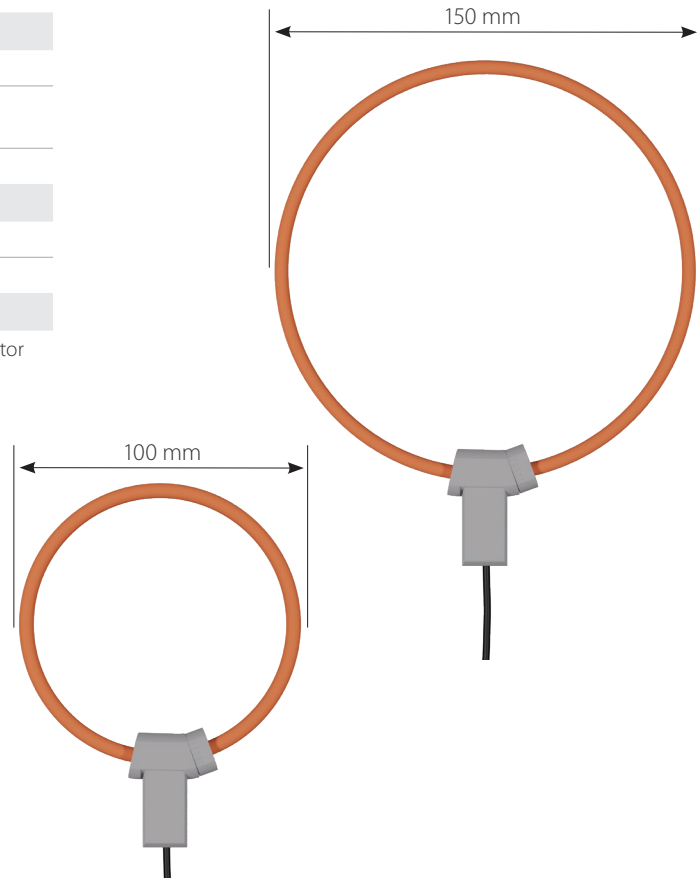

# Ordering

Please use the following table to assist in placing your order with our sales staff.

## Current Sensor

Order No.	Description
S554 0155	SUTO current sensor, 1000 A, 100 mm diameter, open wire ends
S554 0156	SUTO current sensor, 1000 A, 100 mm diameter, including connector to S551
S554 0157	SUTO current sensor, 3000 A, 150 mm diameter, including connector to S551
S554 0158	SUTO current sensor, 3000 A, 150 mm diameter, open wire ends



[www.suto-itec.com](http://www.suto-itec.com)



[sales@suto-itec.com](mailto:sales@suto-itec.com)